

Descrizione Description	Articolo Product code	IN	Finiture Finishes		Misure mm Measures mm											Packaging			Note		
					A	A2	B	C	Ø	D	E	F	G	H	U.M.	Pack	Kg				
Serie / Series <b>271</b> Modello / Model <b>Spranga sfilabile con sormonto</b> Removable bar with surmount	cm 60	<b>FCS 00271 S9</b>	●					600	30	14	25							pcs	5	4,0	
	cm 70	<b>FCS 00271 SA</b>	●					700	30	14	25							pcs	5	4,7	
	cm 80	<b>FCS 00271 SB</b>	●					800	30	14	25							pcs	5	5,5	
	cm 90	<b>FCS 00271 SC</b>	●					900	30	14	25							pcs	5	6,0	
Serie / Series <b>272</b> Modello / Model <b>Spranga ad espansione regolabile</b> Adjustable bar	cm 55 / 75	<b>FCS 00272 0F</b>	●					550	750		22							pcs	5	3,5	
	cm 70 / 98	<b>FCS 00272 0G</b>	●					700	980		22							pcs	5	4,4	
	cm 95 / 123	<b>FCS 00272 0H</b>	●					950	1230		22							pcs	5	5,1	
	cm 120 / 150	<b>FCS 00272 0M</b>	●					1200	1500		22							pcs	5	6,7	
	cm 138 / 167	<b>FCS 00272 0N</b>	●					1380	1670		22							pcs	5	7,1	

Serie / Series  
**271**

Modello  
**Spranga sfilabile  
con sormonto**

Model  
*Removable bar  
with surmount*

Dimensioni /  
Dimensions available  
cm 60  
cm 70  
cm 80  
cm 90

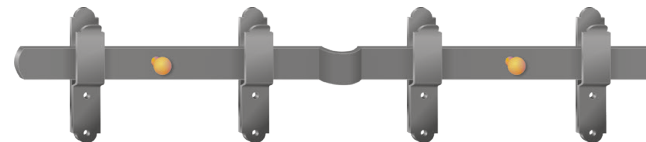

Serie / Series  
**272**

Modello  
**Spranga  
ad espansione  
regolabile**

Model  
*Adjustable bar*

Dimensioni /  
Dimensions available  
cm 55 / 75  
cm 70 / 98  
cm 95 / 123  
cm 120 / 167  
cm 138 / 167

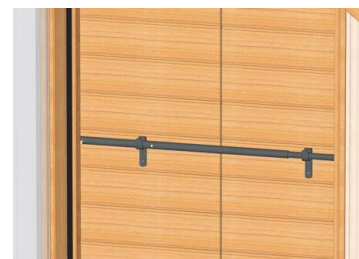

Incontro ad avvitare  
Screwing-in junction

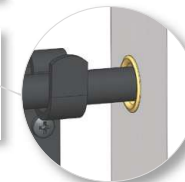

Incontro a muro  
Wall junction

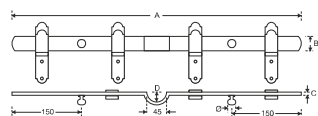

●=IN ferro fondo zincato e copertura polveri poliesteri nero RAL 9005  
zinc treatment iron black powder coating

