





Serie / Series	Modello / Model	Articolo / Product code	Finiture / Finishes			Misure mm / Measures mm													Packaging		Note			
			IS	IG	IR	A	B	C	D	E	F	G	Ø	P	P3	U.M.	Pack	Kg						
Serie / Series ANTICA FORGIA Modello / Model Bandella dritta occhio centrale punta a riccio Strap hinge with central eye curly style		cm 25 FBC 00083 AG	●	●	●	245	35	3,5										12	52	pcs	8	2,1		
		cm 33 FBC 00083 A3	●	●	●	325	35	3,5											12	52	pcs	8		2,8
		cm 40 FBC 00083 A4	●	●	●	395	35	3,5												12	52	pcs		8
Serie / Series ANTICA FORGIA Modello / Model Cardine su perno fisso Pivot on fixed pin		mm 110 - Ø 12 FCA 00083 Y0	●	●	●	110	30			25	195	25	12	12						pcs	4	1,3		
Serie / Series ANTICA FORGIA Modello / Model Bandella dritta occhio centrale punta a cuore Strap hinge with central eye heart style		cm 25 FBC 0083A AG	●	●	●	245	35	3,5										12	52	pcs	8	2,1		
		cm 33 FBC 0083A A3	●	●	●	325	35	3,5											12	52	pcs	8		2,8
		cm 40 FBC 0083A A4	●	●	●	395	35	3,5												12	52	pcs		8
Serie / Series ANTICA FORGIA Modello / Model Cardine su perno fisso Pivot on fixed pin		mm 110 - Ø 12 FCA 00083 Y0	●	●	●	110	30			25	195	25	12	12						pcs	4	1,3		

ANTICA FORGIA



Modello
Bandella dritta
occhio centrale
punta a "Riccio"

Model
Strap hinge
central eye
curl style

Dimensioni /
Dimensions available
cm 25
cm 33
cm 40

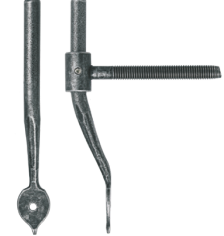

Modello
Cardine
perno fisso

Model
Pivot on
fixed pin

Dimensioni /
Dimensions available
mm 110 - Ø 12

ANTICA FORGIA



Modello
Bandella dritta
occhio centrale
punta a cuore

Model
Strap hinge
central eye
heart style

Dimensioni /
Dimensions available
cm 25
cm 33
cm 40



Modello
Cardine
perno fisso

Model
Pivot on
fixed pin

Dimensioni /
Dimensions available
mm 110 - Ø 12

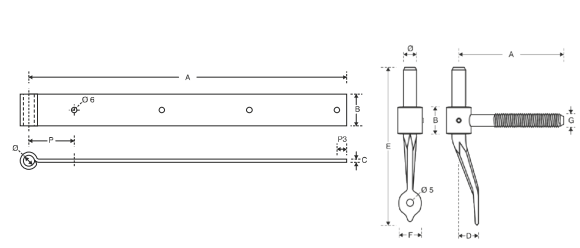

 **Articolo fornito con viteria per il fissaggio**
Product supplied with screws for mounting



IS
ferro con finitura silver
Iron with "silver" finish



IH
ferro con verniciatura polie-
stere grafite
Iron with "graphite" finish



IR
ferro con finitura ruggine
Iron with rust finish

Descrizione Description	Articolo Product code	Finiture Finishes			Misure mm Measures mm										Packaging		Note	
		IS	IG	IR	A	A2	B	C	D	E	P	P3	Ø	U.M.	Pack	Kg		
Serie / Series ANTICA FORGIA Modello / Model Cerniera forgiata punta a cuore Strap hinge handmade heart style	cm 37 SBC 00192 01	●	●	●	367	395	150	3	28			45	33	8	pcs	8	4,52	



**ANTICA
FORGIA**



Modello
**Cerniera forgiata
 punta a cuore**

Dimensioni /
 Dimensions available
 cm 37

Model
 Strap hinge
 handmade
 heart style

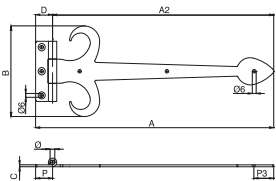

Articolo fornito con viteria per il fissaggio
 Product supplied with screws for mounting



IS ferro con finitura silver
 Iron with "silver" finish



IH ferro con verniciatura polie-
 stere grafite
 Iron with "graphite" finish



IR ferro con finitura ruggine
 Iron with rust finish

Descrizione Description	Articolo Product code	Finiture Finishes			Misure mm Measures mm										Packaging		Note		
		IS	IG	IR	A	A2	B	C	D	E	F	G	Ø	U.M.	Pack	Kg			
Serie / Series ANTICA FORGIA Modello / Model Bandella a "T" occhio centrale punta a riccio "T" hinge with central eye curly style	cm 14 FBC 00084 CS	●	●	●	140		3,5	75	35						10	pcs	4	1,1	_____
	cm 19 FBC 00084 A9	●	●	●	190		3,5	105	35						12	pcs	4	2,2	
Serie / Series ANTICA FORGIA Modello / Model Cardine su perno fisso Pivot on fixed pin	mm 69 - Ø 10 FCA 00083 Z0	●	●	●	69	18		20	150	23	10	10			pcs	4	1,0	_____	
	mm 110 - Ø 12 FCA 00083 Y0	●	●	●	110	30		25	195	25	12	12			pcs	4	1,3		_____



ANTICA FORGIA

Modello / Model
**Bandella a "T"
 occhio centrale
 punta a riccio**
 "T" hinge
 central eye
 curly style

Dimensioni /
 Dimensions available
 cm 14
 cm 19

Modello / Model
**Cardine
 su perno fisso**
 Pivot on fixed pin

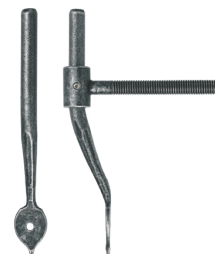

Modello / Model
**Cardine
 perno fisso**
 Pivot on
 fixed pin

Dimensioni /
 Dimensions available
 mm 69 - Ø 10
 mm 110 - Ø 12

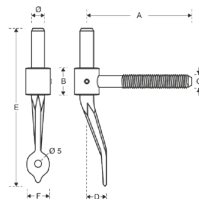
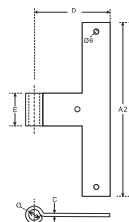

Articolo fornito con viteria per il fissaggio
 Product supplied with screws for mounting

