

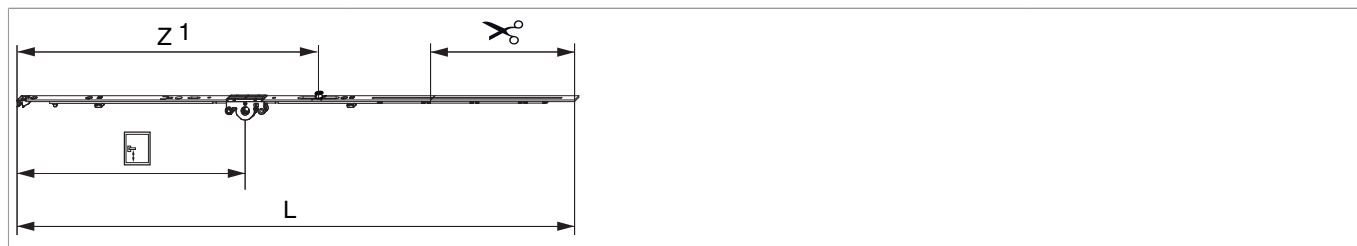

## 201833 - Cremonese A-B Multi Matic 840 E15 fix con 1 fungo HBB 661-840 HM300 argento

### Disegni tecnici



		<b>L</b>						<b>N°</b>
argento	840	736,5	15	300	661 - 840	190,5	20	201833

### Tabella posizionamento viti

<b>N°</b>		1	2	3	4	5	6	7	8	9	10	11	12	13	14
201833	3	18,5	91,5	429											

### Tabella punti di chiusura

<b>N°</b>		Z1	Z2	Z3	Z4
201833	1	395			

### Dime

				<b>N°</b>
Dima forature per fori martellina MM	per punta 3mm		1	203861
Dima forature per fori martellina MM	per punta D=3 mm e D=12 mm		1	203862
Dima completa con guidascontro per cremonese fix MM	con guidascontro L= 48mm	661 - 1.340	1	204774

### Quote della scatola cremonese

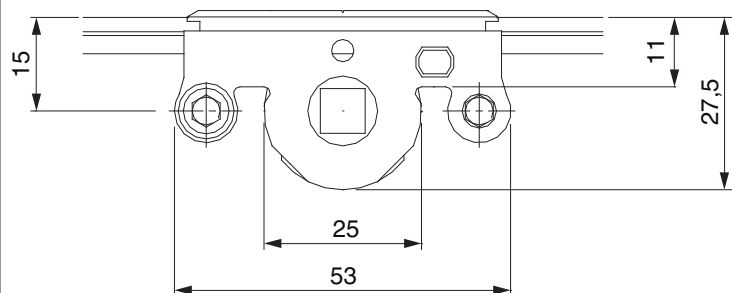

- Larghezza fresata per scatola cremonese 12 mm
- Per fissaggio maniglia utilizzare viti SPAX Ø 5 mm o viti M5.

### Schema di fresata

per PVC e alluminio

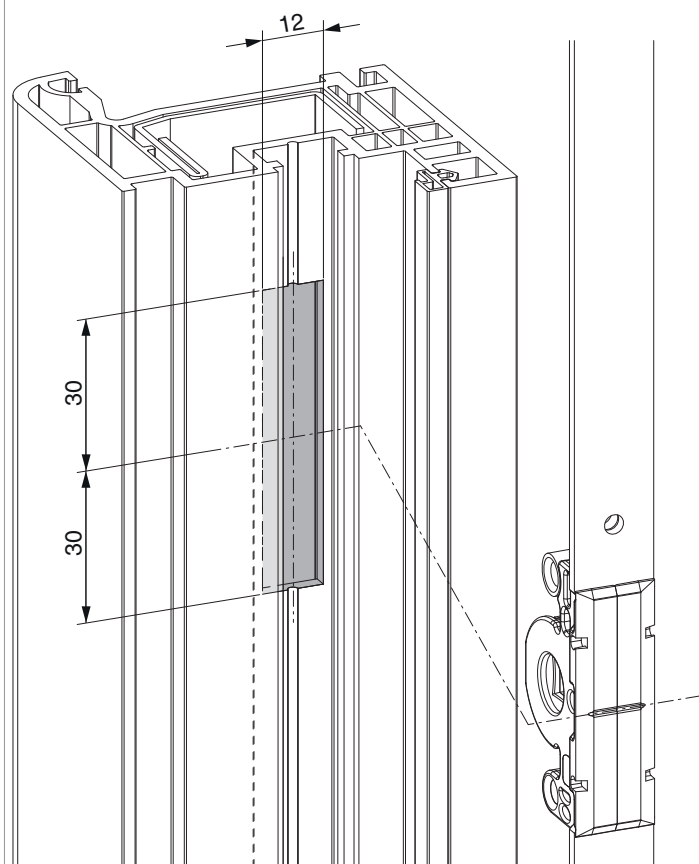

## Schema di foratura

Per serramenti in legno

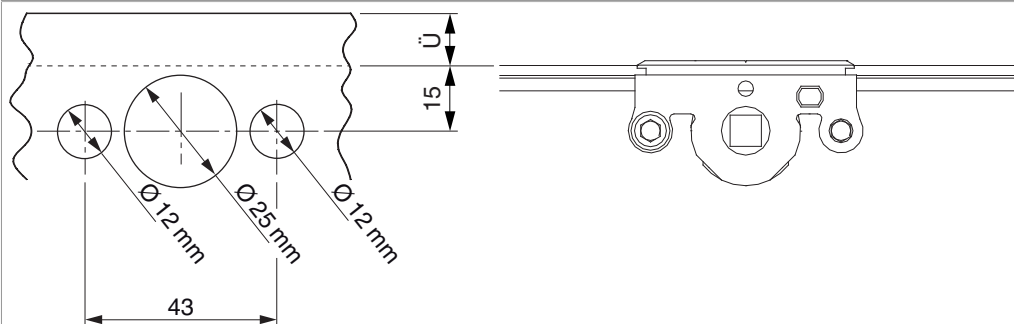

Per serramenti in PVC e alluminio

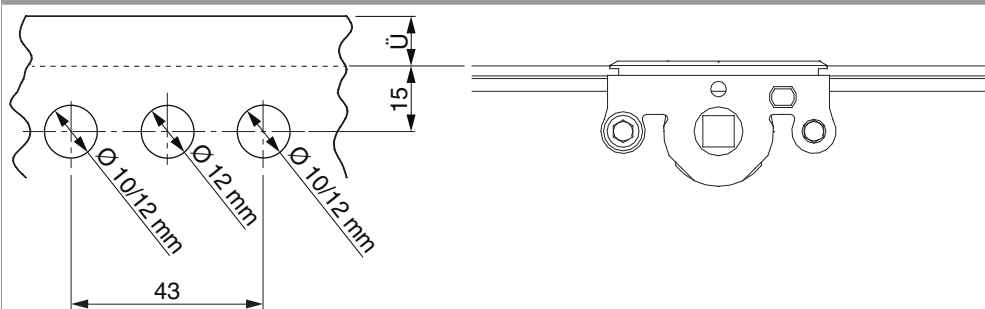

## Schema di tranciatura

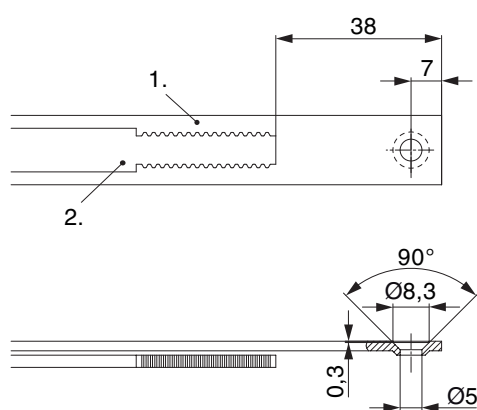

• Consigliamo di trattare il taglio dei componenti TRICOAT-PLUS con la vernice di ritocco TRICOAT-PLUS (cod. 358440).

1. Frontale
2. Asta mobile

## Collegamento a clips

Agganciare collegamenta a clips

①

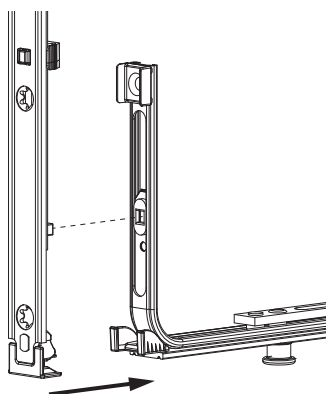

②

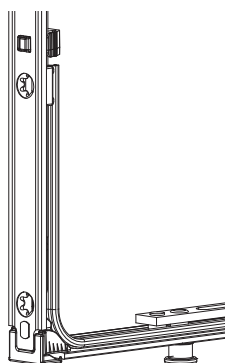

Sganciare collegamento clips

①

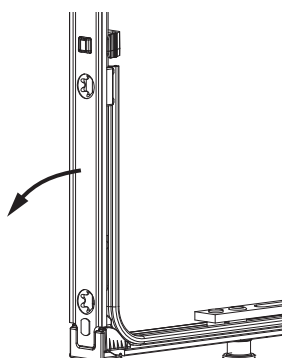

②

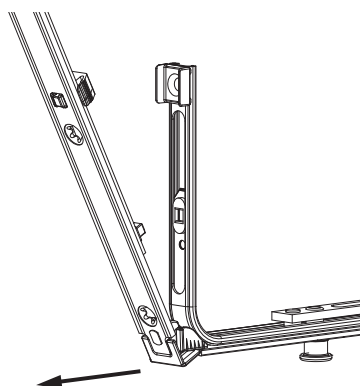

③

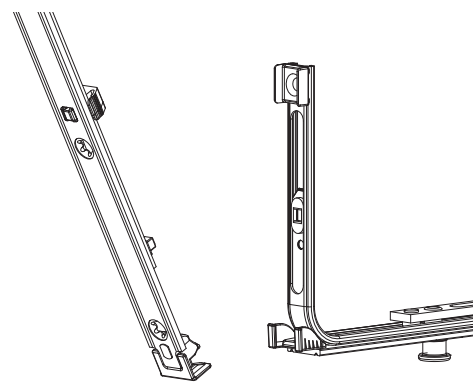

### Collegamento scarpetta dentata

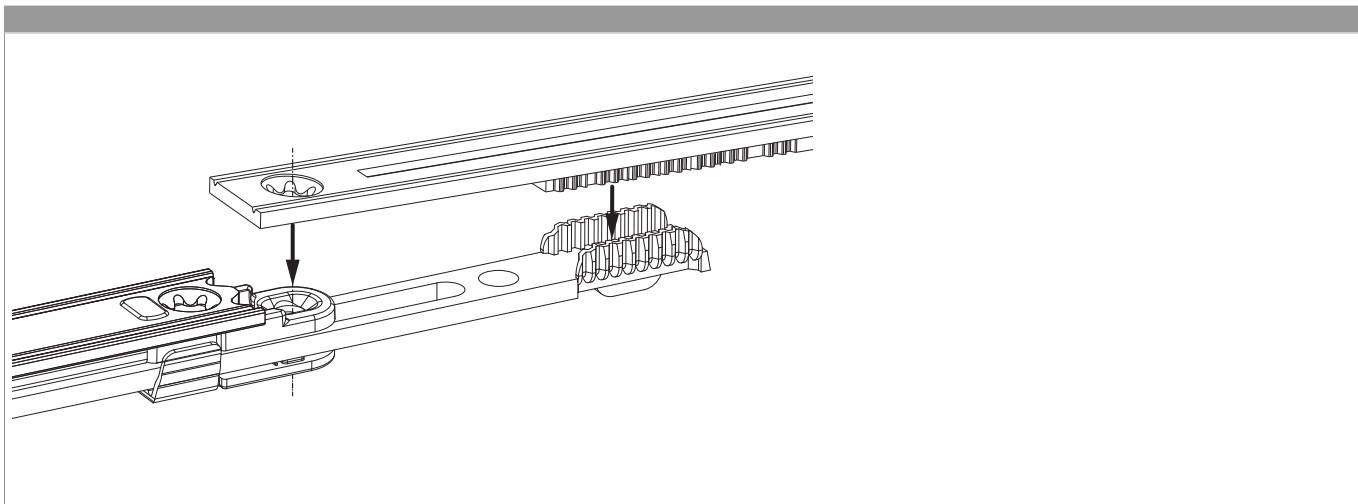

### Regolazione pressione

Fungo e nottolino

