

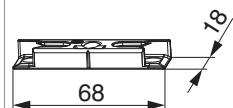



96860 - Scontro fungo battuta liscia/18 con vite inclinata argento

Disegni tecnici



				L	B	H		Nº
argento	Scontro fungo battuta liscia/18	con vite inclinata		68	18	9	100	96860

Sezioni profilo

A12 battuta liscia PB18 - 1 anta

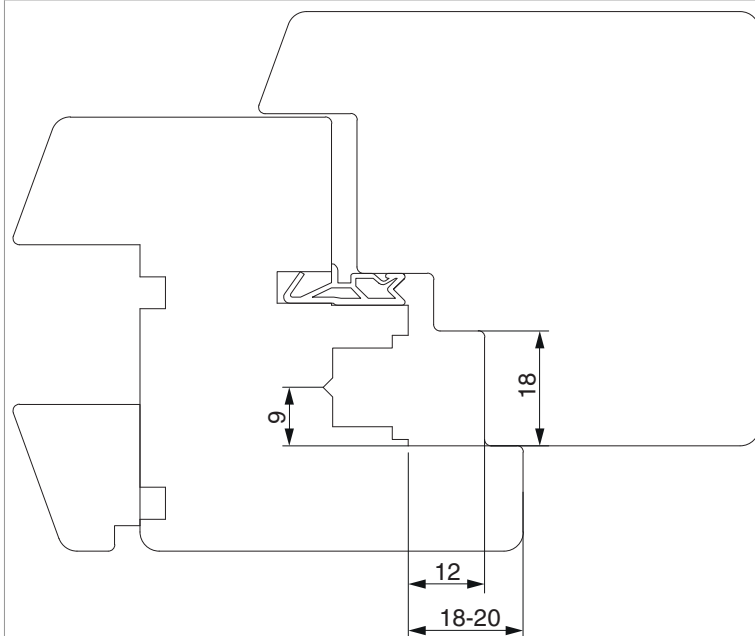

A12 battuta liscia PB18 - 2 ante

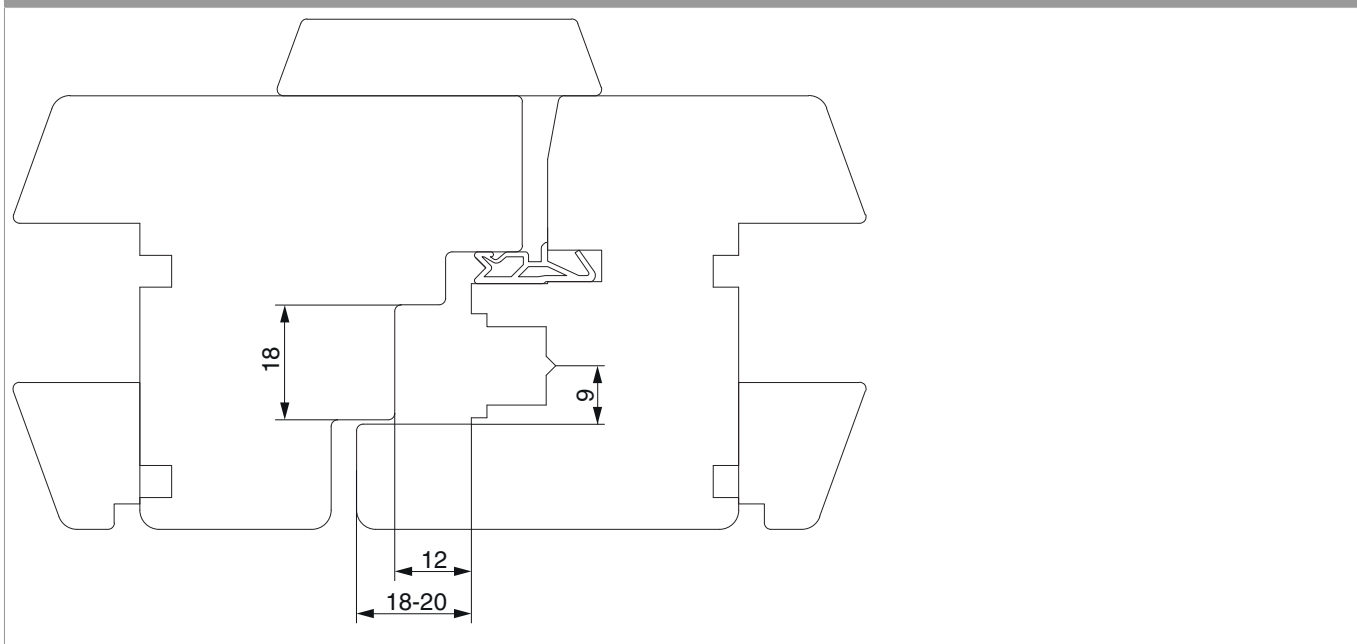

Posizionamento degli scontri

