

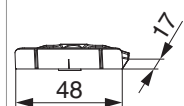



## 34980 - Scontro nottolino battuta liscia/18 con vite inclinata argento

### Disegni tecnici



				L	B	H		Nº
argento	Scontro nottolino battuta liscia/18	con vite inclinata		48	17	9	200	34980

### Sezioni profilo

A12 battuta liscia PB18 - 1 anta

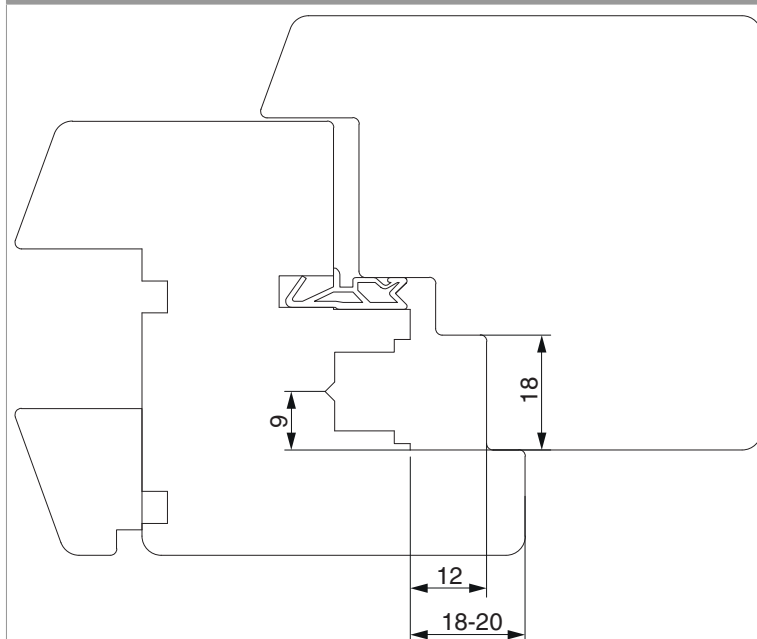

A12 battuta liscia PB18 - 2 ante

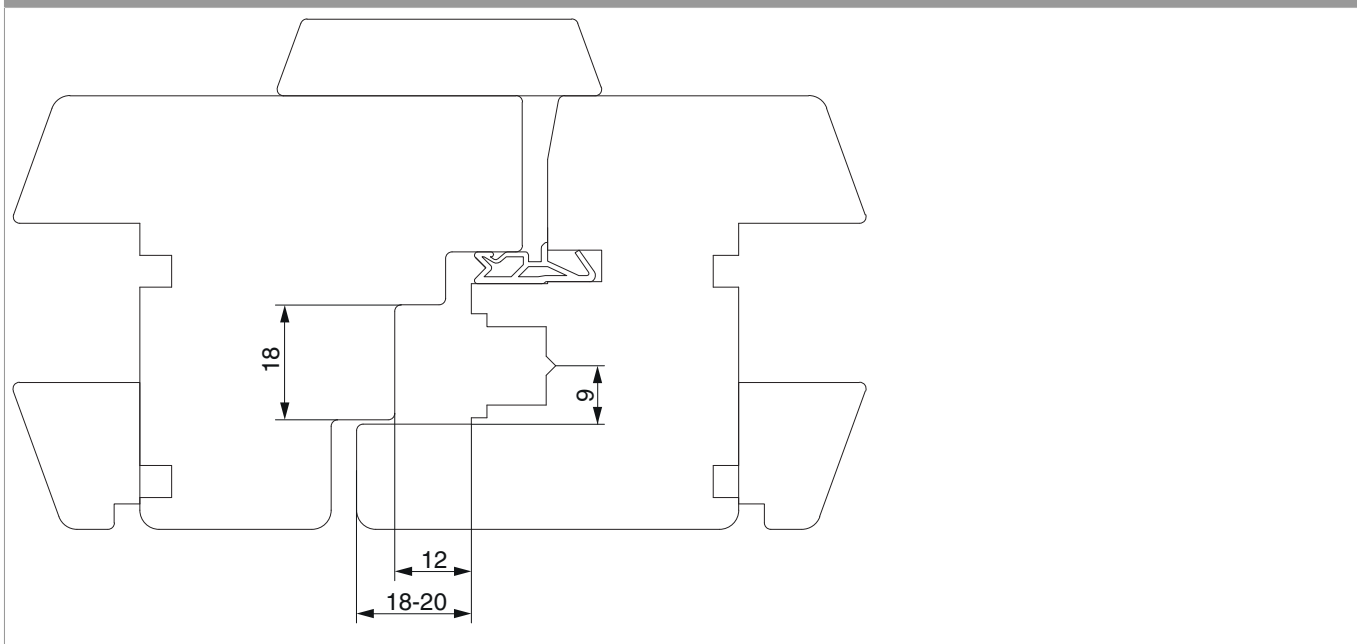

**Posizionamento degli scontri**

